

BACK 2 THE STAGE

TIMES SQUARE

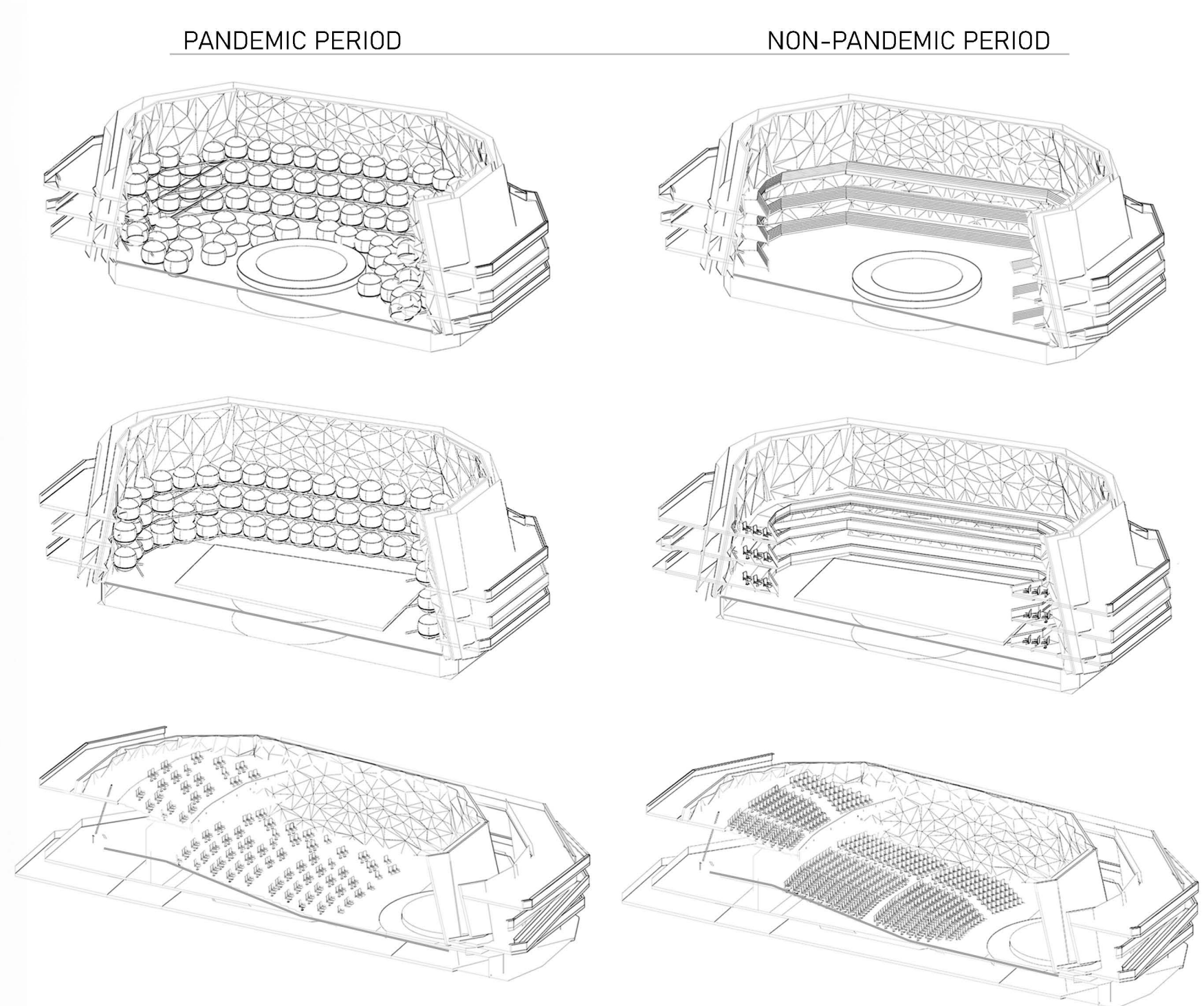
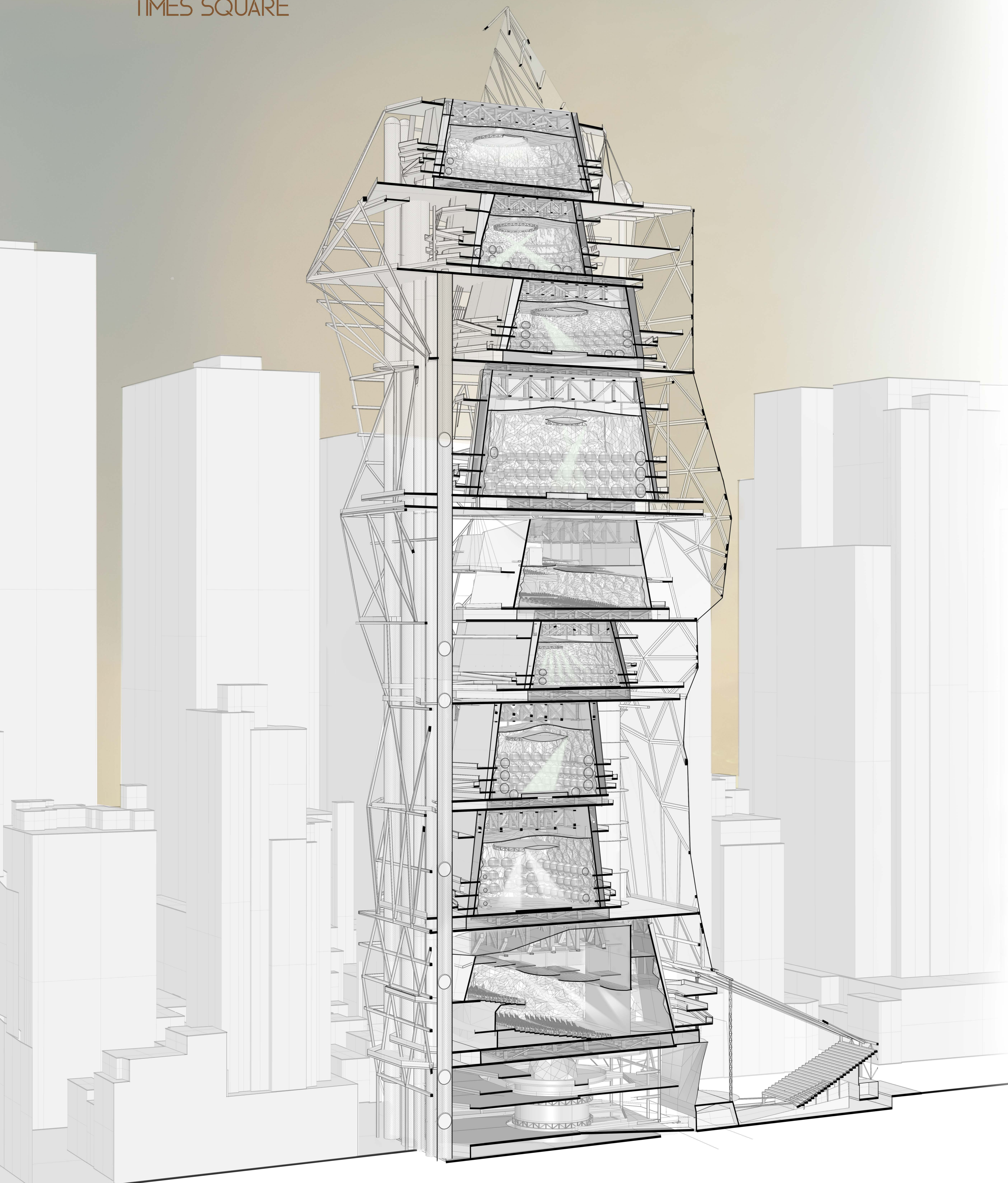

All the venues can function during pandemics, and also can be enjoyable during non-pandemic periods. The venues are adaptable so the users and the artists can interact and enjoy in the most suitable layout.

STAY IN YOUR BUBBLE!

The "Bubble" allows people to experience performance arts while staying safe during a pandemic. The spectators are able to see each other during live events and communicate socially, which is an essential part of the cultural experience that was missed during the pandemic. The bubbles are on a rail, and in allow people to get inside by moving to a neutral area (corridor) hermetically closed. Once people have entered the bubble, it moves back through the rail into the venue.

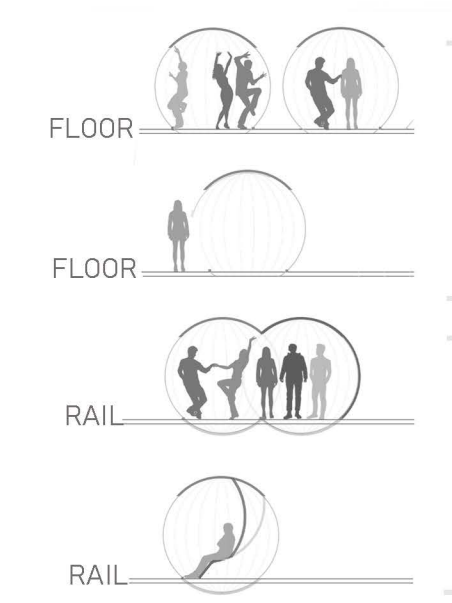
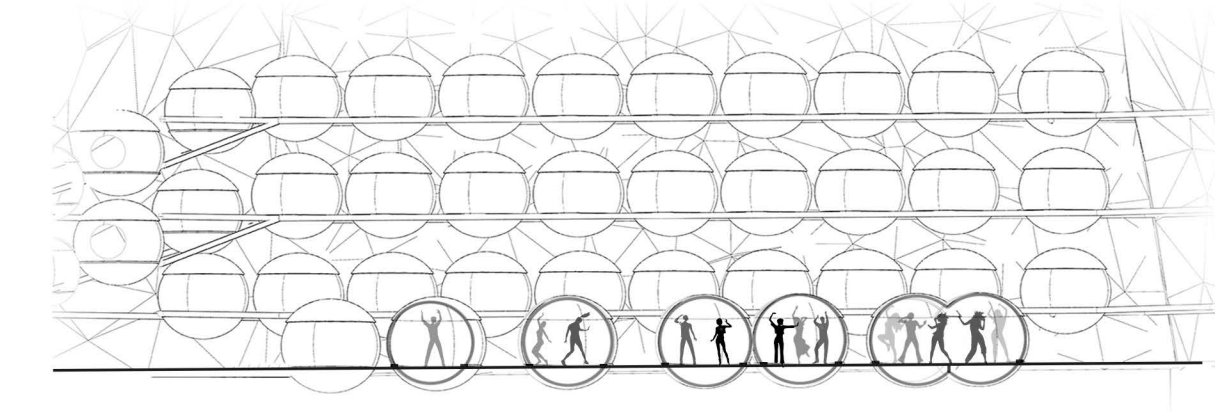
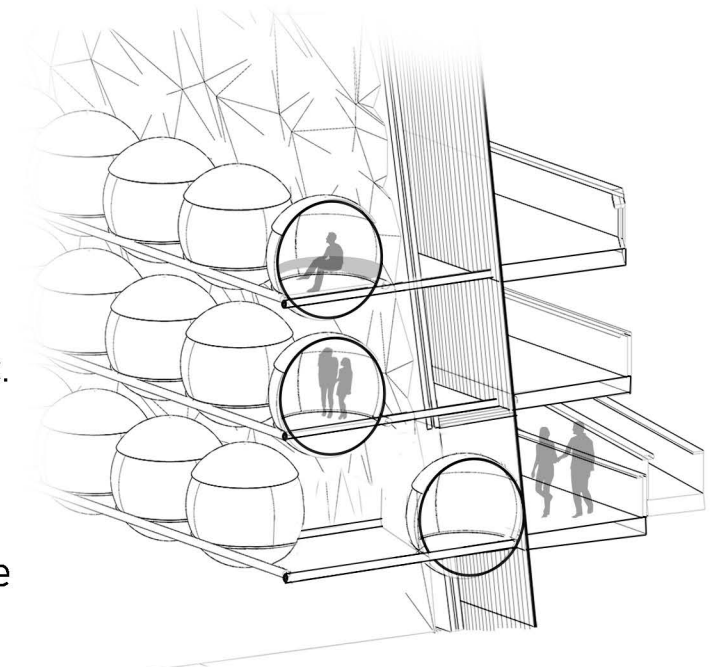

The free Bubble, can be on the floor in the case of central stages or no-stage performances. People are free to move limitless, and due to a rotor with copper coils inside a magnetic housing at the bottom, the whole bubble won't detach from the floor—no airflow will be shared with other people.

When the Bubble is connected to the rail, people can be standing or sitting, and the option to join between two bubbles is given to the users with previous arrangement.

LET'S GO

The same way as it happens backstage, in this building nothing is hidden. The elevators that communicate between all the different venues, are semi-opened, in order to generate constant ventilation.

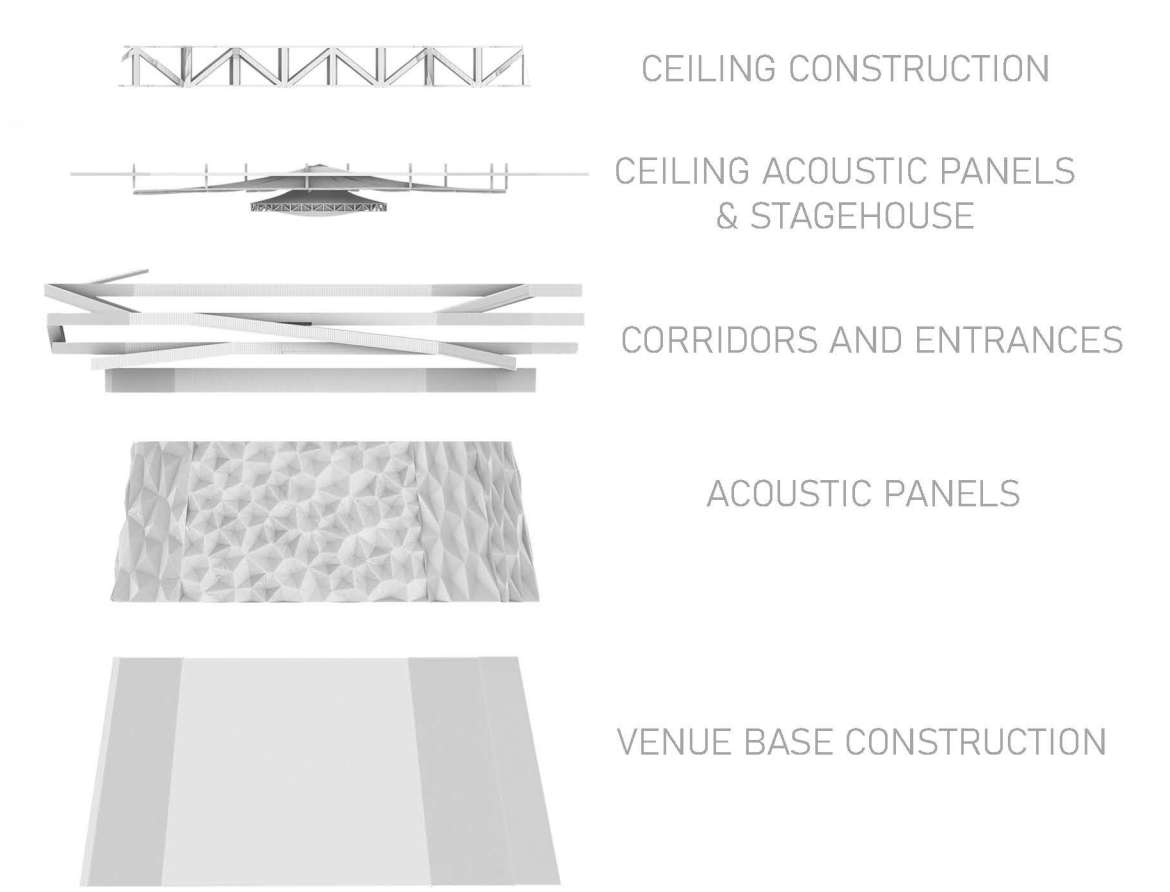

The venues are designed in order to see and be seen. The panels inside, are made by an uneven surface that scatters the sound throughout the venue, and depending on where the sound waves hit the surface, they are reflected in all directions.

FACING THE SQUARE

The position of the building facing Times Square, creates the idea of stage. On the ground floor, there's a stage facing the rest of the square while the building itself is its backstage. The characteristic screens do not take place in this building, but instead, the people itself has the leading role. In some areas on the facade, holograms showing the performances from the venues, will be displayed to the square. The hologram allows to see through even from inside or outside the building.



The experience of the constant interaction and visualization

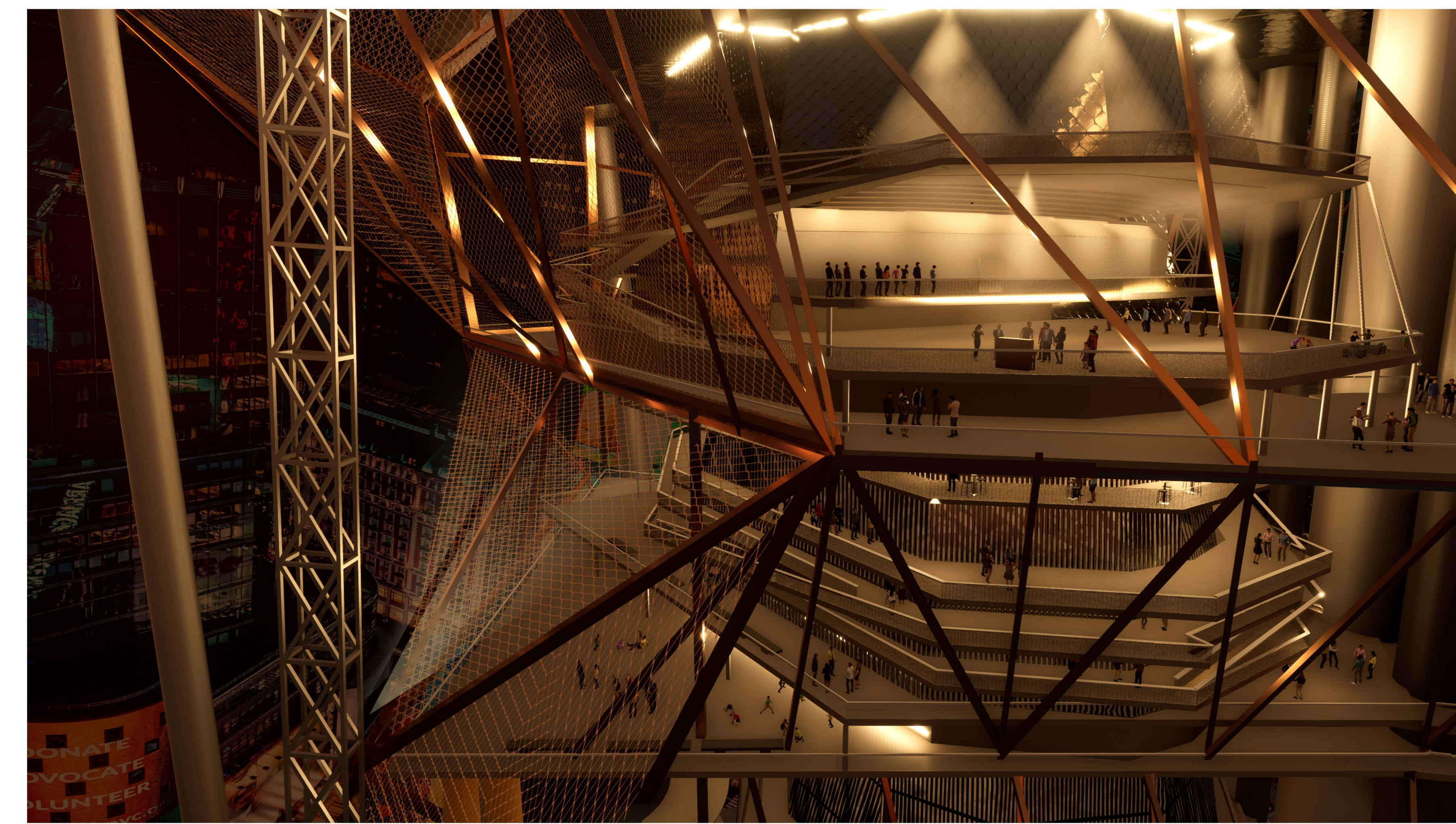

Bien-venue to the new venue style

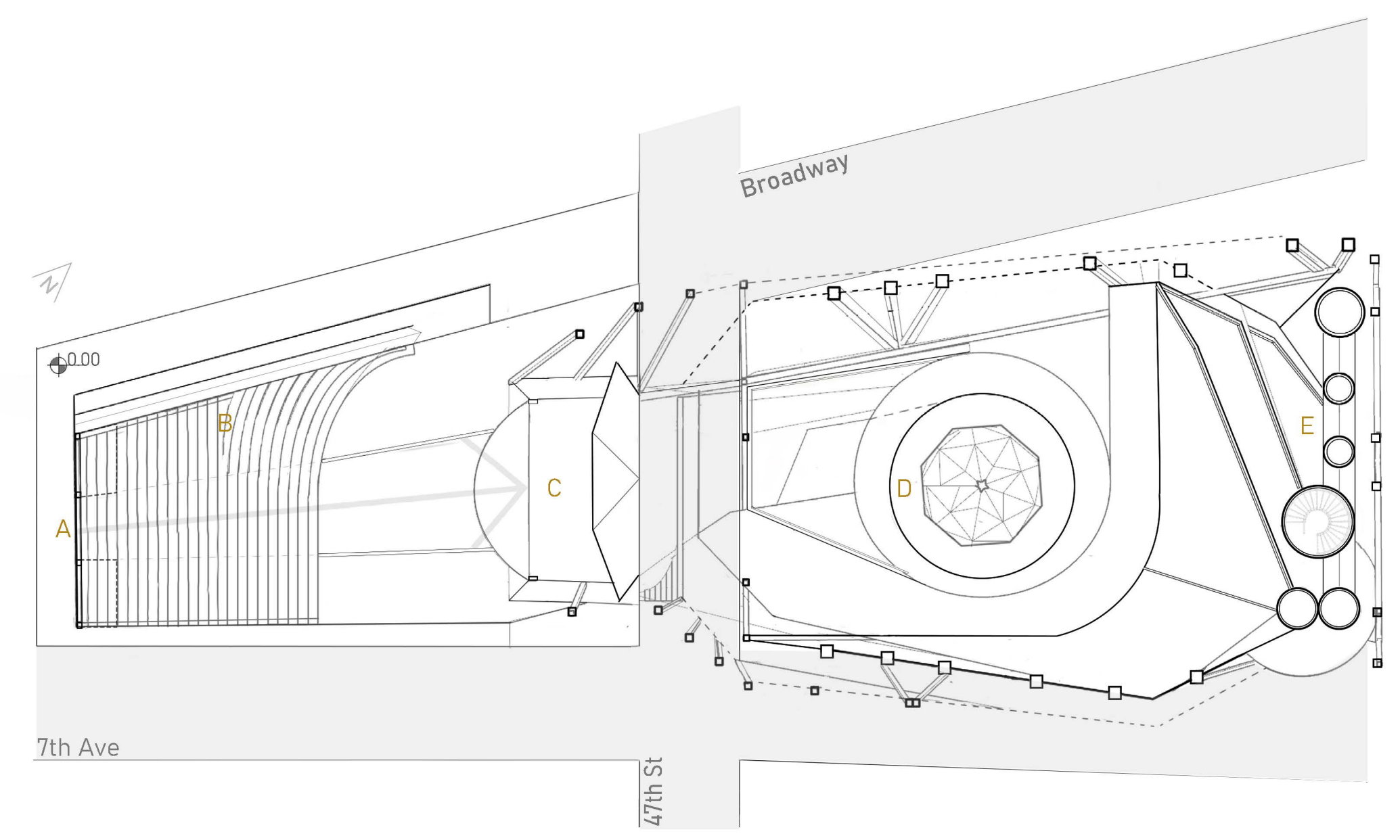

Ground floor plan: staging the square

- A. entrance ramp
- B. steps tribune
- C. open stage
- D. exhibition area
- E. elevators

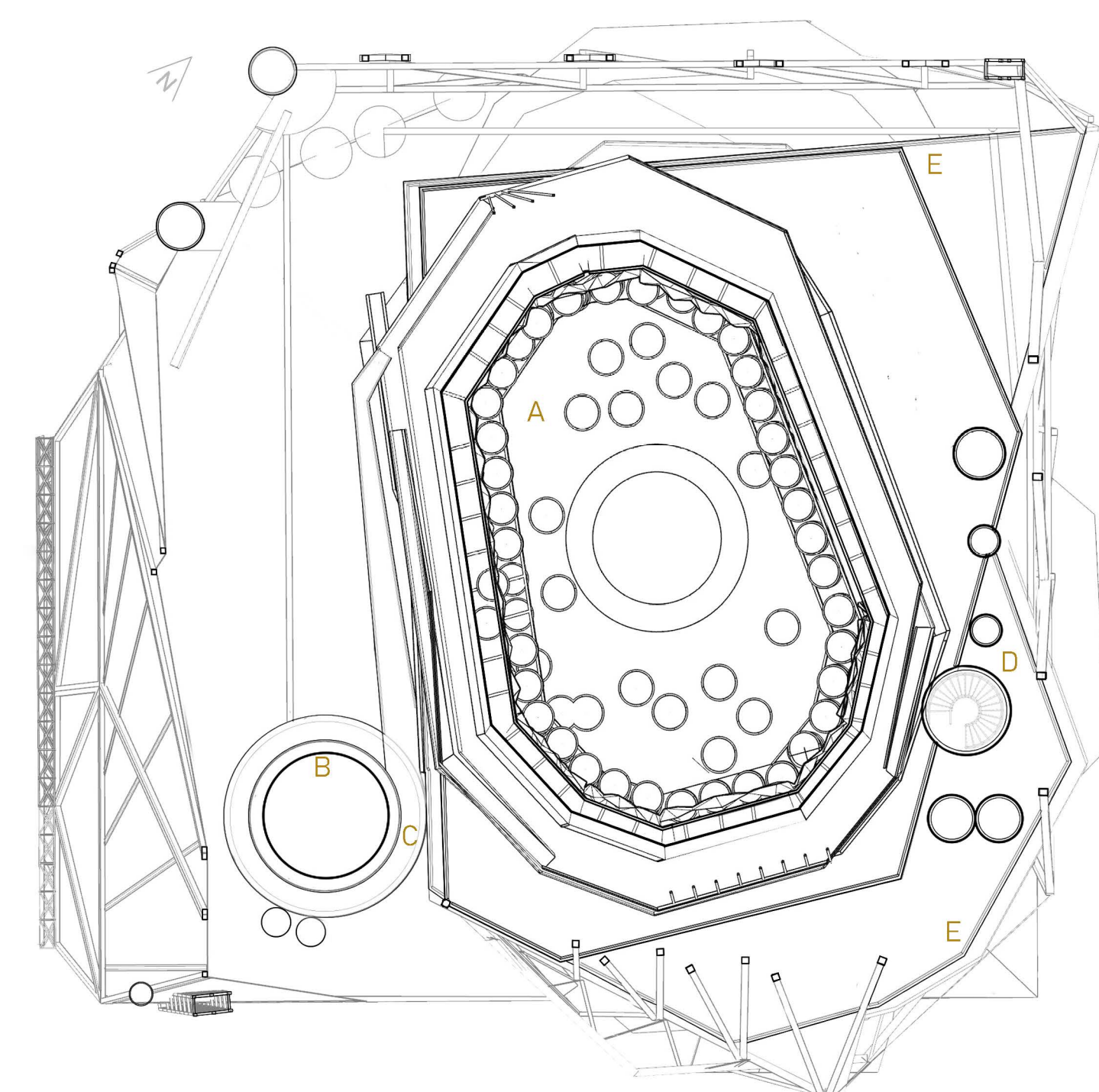

Multifunctional venue floor plan

- A. venue
- B. open bar
- C. exhibition area
- D. elevators
- E. open terrace



Performing arts experience in times of pandemic: seeing and being seen